

NOMAD
YACHTS



Nomad 95



This impressive Nomad 95 is the ultimate in sophisticated ocean-going performance. Featuring a luxurious interior, smart layout with 5 state rooms and a huge tender garage for a rib and two jet skis, her revolutionary design re-defines the use of space on board luxury yachts.

Incorporating the latest construction materials and state-of-the-art technology, this yacht offers amazing comfort and style for adventurous cruising.













STANDARD SPECIFICATIONS

97 ft 8 in
LENGTH (29.77 m)

6 ft 6 in
DRAFT (1.98 m)

130 t approx.
DISPLACEMENT

5 GUEST CABINS
3 CREW CABINS
ACCOMODATION

BEAM	:	24 ft 3 in (7.40 m)
FUEL CAPACITY	:	3,652 US gal (13,825 l)
FRESH WATER CAPACITY	:	740 US gal (2,801 l)
BLACK WATER CAPACITY	:	200 US gal (757 l)
GREY WATER CAPACITY	:	200 US gal (757 l)
EN SUITES	:	5 En Suites + 2 Day Heads
GENERATORS	:	Twin 45kW, 230/400V, 50Hz, 3~phase
ELECTRICAL POWER SYSTEM	:	230/400V AC, 50Hz, 3~phase, 24V DC
POWER OPTIONS	:	Standard - Twin MAN V12-1550, 1550HP, 1140 kW, 2300RPM Compliance to IMO Tier II, No SCR <ul style="list-style-type: none">• Option- Twin MAN V12-1900, 1874 HP, 1397 kW, 2300 RPM Compliance to IMO Tier II• Option - SCR system for Compliance to IMO Tier III
TOP SPEED	:	23 knots*
CRUISING SPEED @ 80% MCR	:	18 knots*
RANGE @ 12 KNOTS	:	1,000 NM*

CLASSIFICATION: Bureau Veritas – Commercial

*Speed estimate may vary depending on cleanliness of hull, and sea conditions.

DECK PLANS

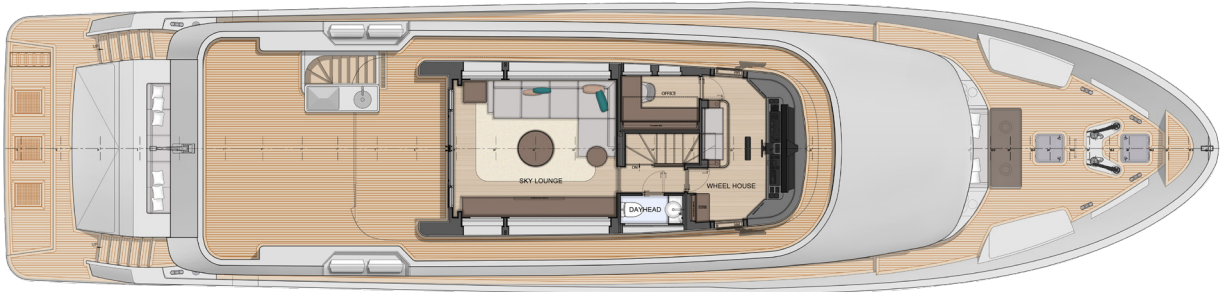

FLY-BRIDGE



MAIN DECK



LOWER DECK